

EXHIBIT MAP OF
 ROMALDO MUTUAL WATER COMPANY
 PROPOSED EASEMENT
 COUNTY OF SANTA BARBARA, CA

OCTOBER 2017

NOTES:

(R) = RECORD OF SURVEY BOOK 43, PAGE 53.

CARDENAS AND
 ASSOCIATES SURVEYING, INC.
 201 N. CALLE CESAR CHAVEZ, STE. 100, SANTA BARBARA, CA 93101
 Phone: (805) 966-3713 Fax: (805) 966-3271
 JOB No. 09-0274

LEGAL DESCRIPTION

APN: 017-285-002

A PORTION OF LOT 10 OF THE GEORGE HANEY TRACT, COUNTY OF SANTA BARBARA, STATE OF CALIFORNIA, AS SHOWN ON A MAP RECORDED IN BOOK 43, PAGE 53 OF RECORD OF SURVEYS, IN THE OFFICE OF THE COUNTY RECORDER OF SANTA BARBARA COUNTY, CALIFORNIA, MORE PARTICULARLY DESCRIBED AS FOLLOWS;

COMMENCING AT THE NORTHWESTERLY CORNER OF LOT 14 AS SHOWN ON SAID MAP, SAID POINT BEING ON THE CENTERLINE OF A PRIVATE ROAD;

THENCE ALONG THE PROPERTY LINES OF LOT 9 AND LOT 10 PER SAID MAP N84°35'50"W 21.20 FEET TO THE TRUE POINT OF BEGINNING;

THENCE LEAVING SAID PROPERTY LINE N00°34'47"E 35.11 FEET;

THENCE N59°31'01"E 31.55 FEET;

THENCE N84°03'00"E 21.48 FEET;

THENCE S72°25'51"E 28.04 FEET;

THENCE S05°43'07"W 51.79 FEET TO A POINT ON THE SOUTHERLY PROPERTY LINE OF LOT 10 AND THE NORTHERLY PROPERTY LINE OF LOT 14 PER SAID MAP;

THENCE ALONG THE SOUTHERLY PROPERTY LINE OF LOT 10 AND THE NORTHERLY PROPERTY LINES OF LOT 9 AND LOT 14 PER SAID MAP N84°35'50"W 70.80 FEET TO THE TRUE POINT OF BEGINNING;

Said land described contains 3,743 SQUARE FEET

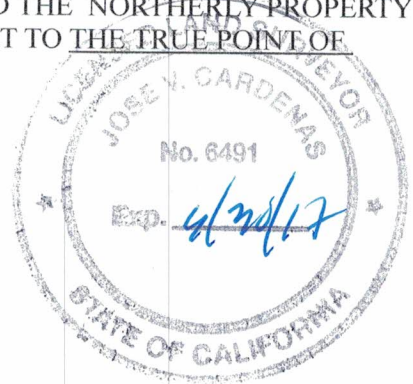

END OF DESCRIPTION

Prepared By: Jose V. Cardenas
Jose V. Cardenas, L.S. 6491

Date: 3/27/17